

ArcGIS Online

Empowers New Mexico State Land Office Project Management



Bill Baillargeon
New Mexico State Land Office
Santa Fe, New Mexico
wbaillargeon@slo.state.nm.us

Courtney Moore
Timmons Group
Richmond, Virginia
courtney.moore@timmons.com



Institutional Setting

New Mexico State Land Office

- Steward of New Mexico's state trust lands
 - 9 million acres of surface estate
 - 13 million acres of subsurface estate
- Generates revenue for state's public institutions
 - FY 2009 - \$567M FY 2010 - \$602M FY 2011 - \$611M
 - FY 2012 - \$658M FY 2013 - \$584M FY 2014 - \$817M
- Rights-of-Way
 - 17,000 ROWs in 2012
 - 19,400 ROWs now

ROW Project Overview

- Phase 0: Requirements
- Phase 1: Implementation
 - Geodatabase model
 - Workflows
 - Conversion Pilot
 - UC 2012: *Production Mapping and Parcel Fabric Shaping Rights-of-Way at the New Mexico State Land Office*
- Phase 2: Production



What We're Doing Now

- Production process
- Digitizing at Timmons Group
- QA at State Land Office

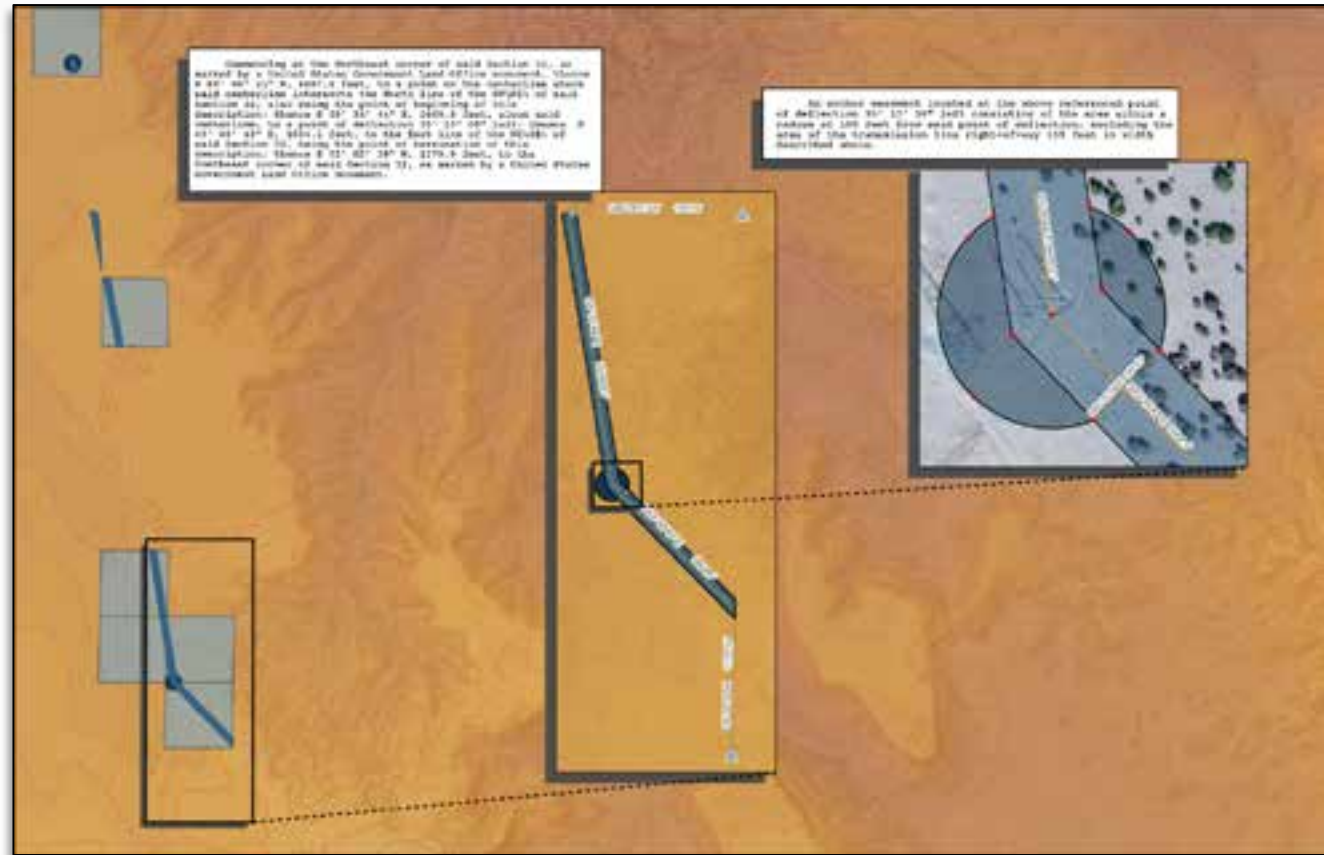

ArcGIS Online

- Utilizing both State Land Office and Timmons Group organizational accounts
- State Land Office NM ROW group containing Maps and Apps





- EDIT
- INVITE USERS
- MEMBERSHIP REQUESTS
- CHANGE OWNER
- DELETE GROUP
- SHARE

New Mexico ROW project ▾

Group Content

All Results

- Maps
- Layers
- Scenes
- Apps
- Tools
- Files

Show ArcGIS Desktop Content

	Title	Owner	Rating	Views	Date
	New Mexico ROW App Application used to review the NMSLO ROWs. Web Mapping Application by TimmonsAGOL Last Modified: October 29, 2014 (0 ratings, 0 comments, 12 views)				X
	New Mexico ROW Map Web map for NMSLO ROW Web Map by TimmonsAGOL Last Modified: November 4, 2014 (0 ratings, 0 comments, 47 views)				X
	NMROW status sheet Document Link by TimmonsAGOL Last Modified: November 3, 2014 (0 ratings, 0 comments, 0 views)				X

Facebook Twitter

Group Details

TimmonsAGOL
Status: public
Contributors: All members
Tags:
New Mexico State Land Office, ROW, Parcel Fabric

11 Members

- TimmonsAGOL
- courtnee X
- da_martinez X
- k_baco X
- m_armijo X
- m_rael X
- p_jaramillo X
- p_esquibel X
- RoddyMartinez X
- TaylorHopkins X
- wballergen X

PREVIOUS NEXT

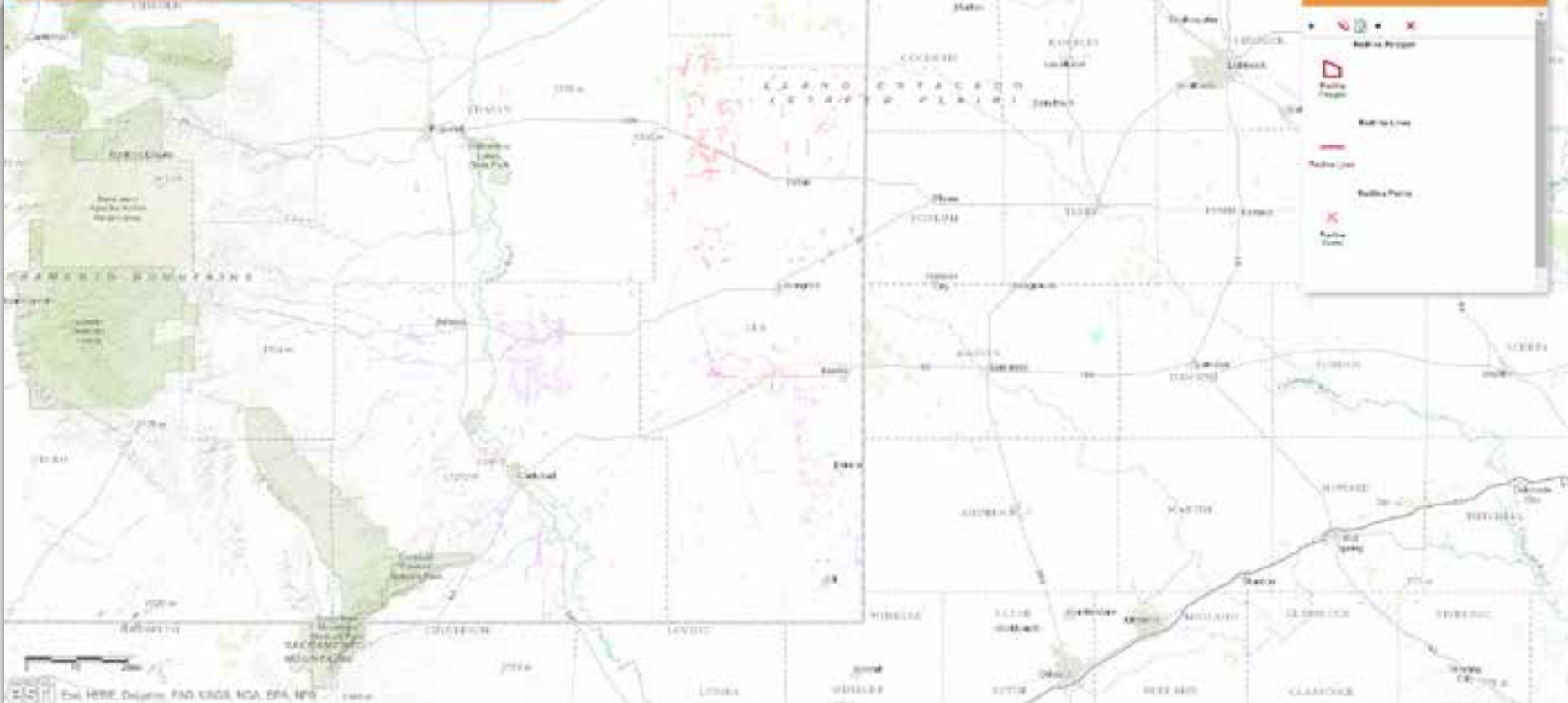

Benefits

- Real time
- Tools to review
- Value added to project

Quality Control

Facilitating the process

- Communications
- Redlining
- Google Sheets

The screenshot displays an ArcGIS web application interface. At the top, a navigation bar shows the title 'New Mexico Rights-of-Way' and a search box containing 'R31378'. Below the navigation bar is a map showing a parcel boundary in orange and a right-of-way boundary in purple. A scale bar at the bottom left indicates 0, 50, and 100 feet. A metadata window on the right side of the map displays the following information:

Parcels: R31378	
Name	R31378
Type	Pipeline/Hydrocarbon
StatedArea	0.2017 a
SystemStartDate	June 25, 2015
SystemEndDate	
LegalStartDate	February 4, 2009
LegalEndDate	February 4, 2044
Page Number	1
ROW Prefix	R
ROW Number	31,378
ROW Suffix	
Rods in ROW	17.75
ROW Width in Feet	30.00
DORID Code	217,267
SLO Status	Active
Acres in Row	0.20

At the bottom of the interface, the ESRI logo is visible, along with the text: 'Esri, HERE, DeLorme, Intermap, iPC, USGS, USDA, EPA'.

New Mexico Rights-of-Way

03/17/21



Edit

- Redline Polygon
- Redline Lines
- Redline Lines
- Redline Points
- Redline Points

Keeping Track of ROWs

NMROW 2014-2015

File Edit View Insert Format Data Tools Add-ons Help All changes saved in Drive

123

	A	B	E	F	G	H	I	J	K	L	M	N
	ROWName	Editor	Difficulty	Format	Year	Coverage Area	Multi-Structure	Time in hours	QAQC Status	Comments	NMSLO Status	Comments from NMSLO
171	R16895	LM	Medium	Legal Description with Bearings and Lengths	3	Extra Large	No	6	Complete	Missing rods.	Ready for Review	
172	R16899	LM	Medium	Legal Description with Bearings and Lengths	3	Small	No	0.75	Complete	Missing rods.	reviewed	accurate
173	R16901	LM	Medium	Legal Description with Bearings and Lengths	3	Medium	No	2	Complete	Missing rods.	reviewed	accurate
174	R16916	LM	Medium	Legal Description with Bearings and Lengths	3	Small	No	1	Complete	Missing rods.	reviewed	accurate
175	R16919	LM	Medium	Legal Description with Bearings and Lengths	3	Extra Large	No	2.25	Complete	Missing surveyor (illegible) & rods.	Ready for Review	

Framework

- ArcGIS Online organizational accounts
- ArcGIS for Server services at Timmons Group
 - 10.2 ArcGIS for Server
- Services linked to ArcGIS Online
- State Land Office ROW Group



Bill Baillargeon
New Mexico State Land Office
Santa Fe, New Mexico
wbaillargeon@slo.state.nm.us

Courtney Moore
Timmons Group
Richmond, Virginia
courtney.moore@timmons.com

