

ArcGIS Pro Panel

Stefan Balbo

Michael Grossman

Jeremy Wright

Jim McKinney

Phil Sanchez

Todd Stellhorn

Ty Fitzpatrick

Drew Flater

Kirsten Pinkston

Kory Kramer

Rob Elkins

Welcome



Panel Discussion

Not Technical Workshop

Potential Agenda

- **Getting Started**
- **Road Map**
- **Mapping 2D and 3D**
- **Geoprocessing \ Analysis**
- **Editing**
- **Extensions**
-

ArcGIS Desktop

The product



ArcGIS Desktop

The applications

ArcGIS Pro



ArcMap



ArcCatalog
ArcScene
ArcGlobe

ArcGIS Desktop | Professional GIS

ArcGIS Pro 2.0



Improvements

- Annotation Editing
- Measured Grids
- Charts and Graphs
- WFS
- 3D Editing
- Customization

New

- Orthomapping
- Massive Point Clouds
- Vector Tiles
- Dynamic Aggregation
- Arcade Expressions
- Data Exploration
- GeoAnalytics Integration

Coming

- Utility Network
- Metadata
- Parcels

Advanced Mapping, Visualization, Editing, and Analysis

*Pro Is the New Standard . . .
. . . For Desktop GIS*

Is ArcGIS Pro a Replacement for ArcMap?

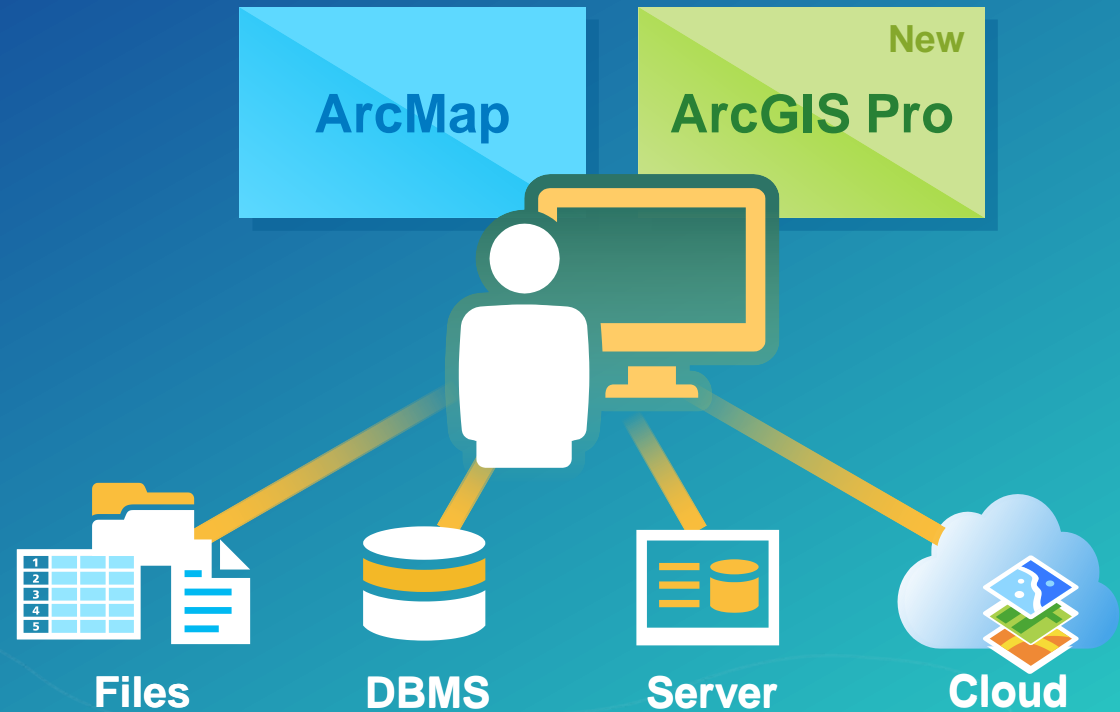

Is ArcGIS Pro a Replacement for ArcMap?

- Yes
- ArcMap still supported
 - But not supported forever
- Eventually ArcGIS Pro will replace ArcMap



ArcGIS Pro is the future for desktop GIS

What is the plan for ArcMap?

- ArcMap continues
 - Minor updates \ bug fixes

ArcMap 10.5.1

ArcMap 10.6



Desktop Product Life Cycle

Getting Started With ArcGIS Pro

Setup

- Download and Install
- Sign-in and Authorize
- Get Updates
- Set Display Language



Migration

- Take inventory
- Create, connect, import
- Analyze results
- Consult resources

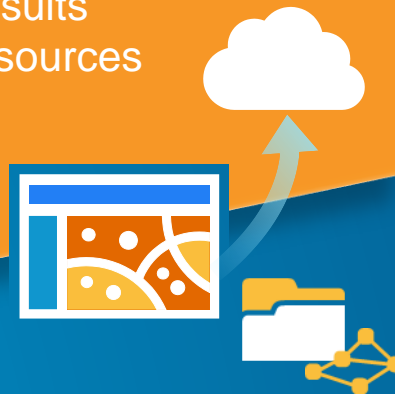

Resources

- Tutorials
- Terminology Guide
- [Supported data types and items](#)
- Virtual Campus



ArcGIS Pro Resources

Video Tour

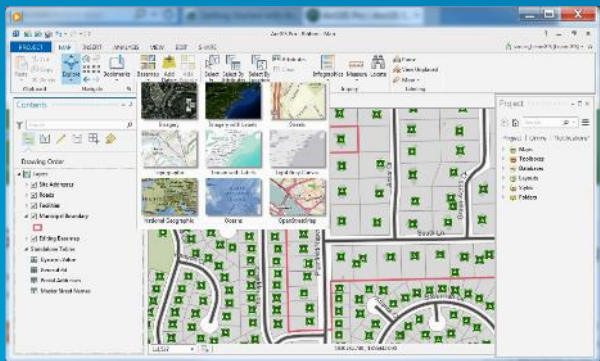

ArcGIS Pro Help

Quick-start tutorials

Migrate content

Navigate your data

Symbolize your data

Label your map



Terminology Guide

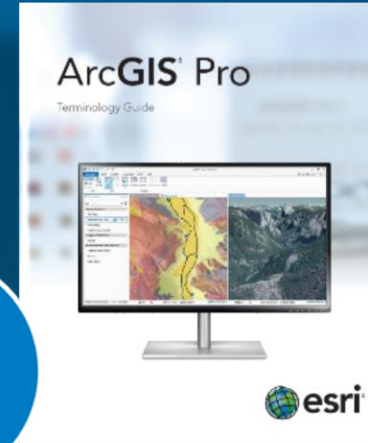

Essential Terminology or Functionality That's New to ArcGIS Pro		
ArcGIS Pro	Usage	Similar Concepts in Other ArcGIS for Desktop Applications
Project	A collection of related geographic information, maps, scenes, source settings, and other resources in a single file.	
Map	The workspace in which display and edit content (vector data, data layers, symbology, etc.) in map view.	Contents pane
Scene	The workspace in which display and edit content (vector data, data layers, symbology, etc.) in 3D view.	3D content pane
Table	The workspace area across the top of the ArcGIS Pro interface that displays content from a data source.	Table of contents pane and Catalog pane
Tab in the table	A section or tab within the table interface.	Section
View	The workspace containing display and edit content in a 2D or 3D view.	Similar to a map area or layout view, but limited to other types in ArcGIS Pro.
Active view	The view that currently has keyboard focus. The active view controls the contents of the table.	Active data frame
Layer	A collection of elements in a content pane that are not part of a scene.	Content pane element
Color	A numerical value or graphic that displays a range of properties and is used to guide an analysis or workflow.	
Toolbox	A collection of tools located on the left side of the ArcGIS Pro interface.	Similar to functionality in the Tool Bar and Manager interface
Click to access		
Panel	Connection to an ArcGIS Online or ArcGIS Enterprise resource.	Unified ArcGIS Environment in ArcGIS Pro, and the Content and Project tabs in Project pane

Getting Started with ArcGIS Pro

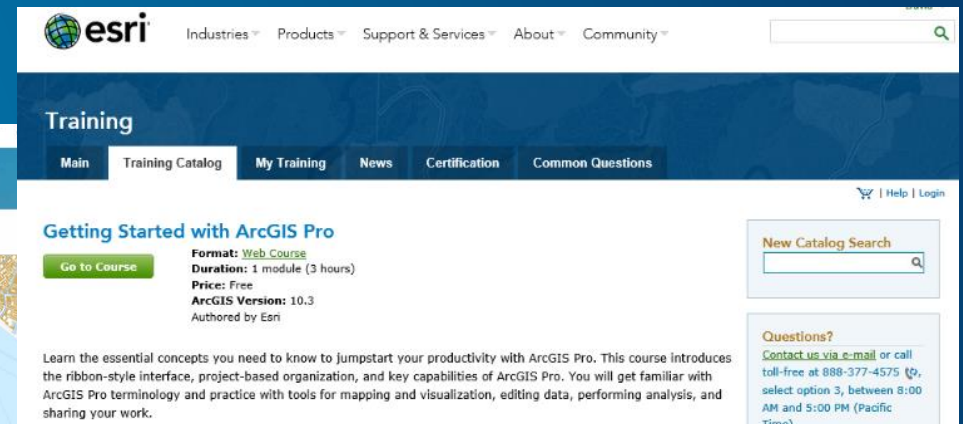

Publications

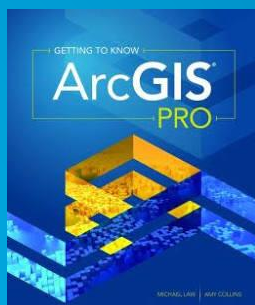
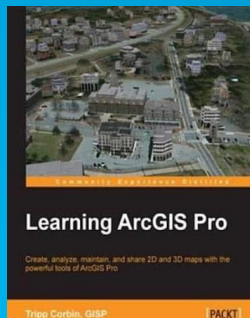

Learn ArcGIS

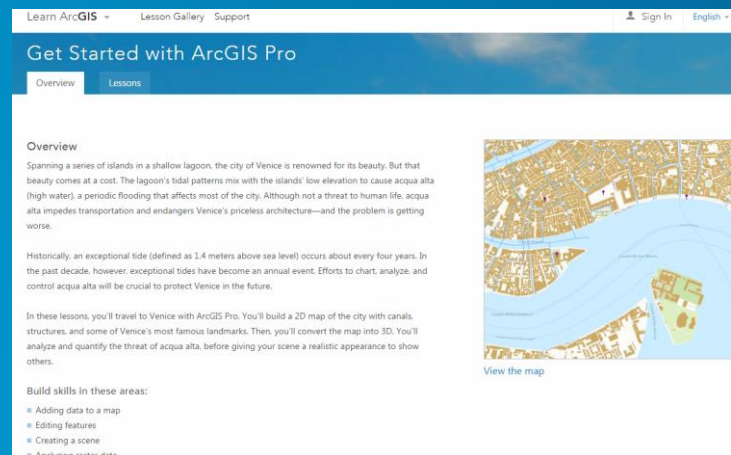

Responding to your education and training requests

Learning Resources – Overcoming the learning curve

- 76 ArcGIS Pro tutorials, web courses, videos and seminars on esri.com/training
- 15 Quick-start tutorials in Get started with ArcGIS Pro
- 11 ArcGIS Pro lessons on learn.arcgis.com
- 3 books plus a 4th on the way

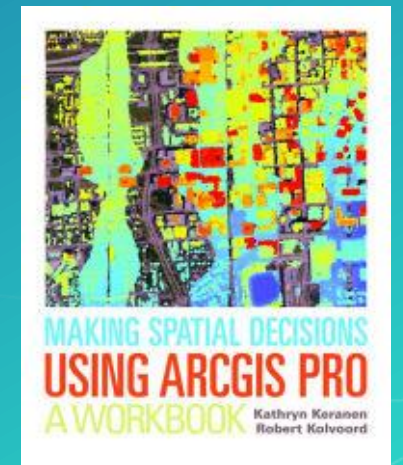
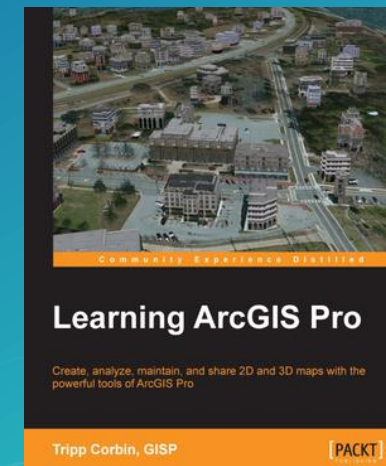
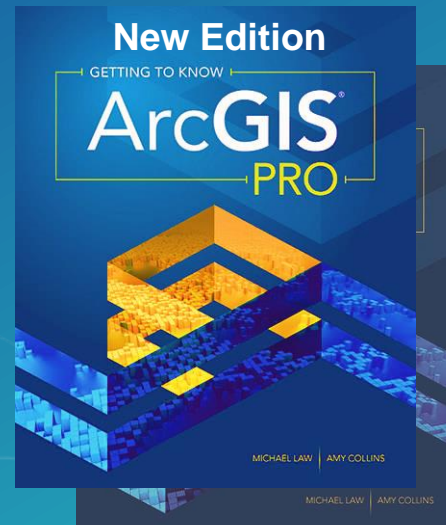

Pro.ArcGIS.com

ArcGIS Pro | ArcGIS Desktop

pro.arcgis.com/en/pro-app/

ArcGIS Desktop

ArcGIS Pro ArcMap

SEARCH

Sign In

English



ArcGIS Pro

FREE TRIAL

Home

Get Started

Help

Tool Reference

ArcPy

SDK

Community

The Foundation for Your GIS

Build projects from your maps, data, analytical models, and more with ArcGIS Pro. Collaborate with others in your organization and share your work with everyone on the web.

Search ArcGIS Pro Help



Version: 2.0 (June 2017)

[System requirements](#)

[Download & install](#)

[What's new in 2.0](#)

[Release notes](#)

[FAQ](#)

ArcGIS Pro Virtualization



ArcGIS Desktop Virtual Appliance ADVA

ArcGIS Pro as a hosted application running on the following virtualized environments

Virtual Desktop Infrastructure (VDI)**

Citrix XenDesktop 7.5
Citrix XenDesktop 7.6
Windows Server 2012 R2 Hyper-V
VMWare vSphere 6.0 Horizon View

**Citrix VDI certified with NVIDIA GRID driver 346.68/348.27

**Microsoft VDI certified with NVIDIA GRID driver 346.68/348.27

**VMWare VDI certified with NVIDIA GRID driver 346.68/348.27

Citrix XenApp*

Version	Hosted OS	Minimum OS version
Citrix XenApp 6.5	Windows Server 2008 R2	SP1
Citrix XenApp 7.6	Windows Server 2008 R2	SP1
	Windows Server 2012 R2	Update: April 2014

*A GPU compatible with your virtualization platform is recommended.

System Requirements

Community



Pro virtualizes for any organization



ArcGIS Ideas

- Visit ideas.arcgis.com to:
 - Vote
 - Comment
 - Submit new ideas
- ArcGIS Pro team wants your feedback!
 - Regular review
 - Your use case matters
 - Your ideas can result in new features for everyone

Put your
Ideas in Motion



Visit the ArcGIS Ideas space on GeoNet

Responding to your requests and feedback

ArcGIS Desktop Ideas On the Move: June 2017

Blog Post created by [Kory Kramer](#) on Jun 27, 2017

Like • 1

Comment • 4

With today's release of ArcGIS Pro 2.0, it's time for another summary of what's happening with Ideas.

11 Desktop ideas have been moved to **Implemented**:

- 💡 Run more than one instance of ArcGIS Pro
- 💡 Saving Service and SDE Connection in ArcGIS Pro
- 💡 Grid and Graticules
- 💡 Rename Shapefiles (better data-management) in ArcGIS Pro (1.4)
- 💡 Make Enterprise GDB Connections User-Wide for ArcGIS Pro
- 💡 Using a Web Feature Service (WFS) without converting it to a feature layer (ArcGIS Pro)
- 💡 ArcGIS Pro: Rearrange Fields in Field View
- 💡 Exporting Data from Project View in ArcGIS Pro
- 💡 Native/Direct WFS Support in ArcGIS Pro
- 💡 ArcGIS Pro - Extract Data tool - polygon input as in ArcMap
- 💡 ArcGIS Pro: Allow connection to .sde files in folders

2 Desktop ideas have been moved to **In Product Plan**:

- 💡 Drag & Drop Data into ArcGIS Pro
- 💡 Add full OGC WFS support in next version of ArcGIS Desktop (no extension use)

2 Desktop ideas have been moved to **Under Consideration**:

- 💡 Add an autosave feature for ArcGIS Desktop.
- 💡 Add Direction to the Measure Tool

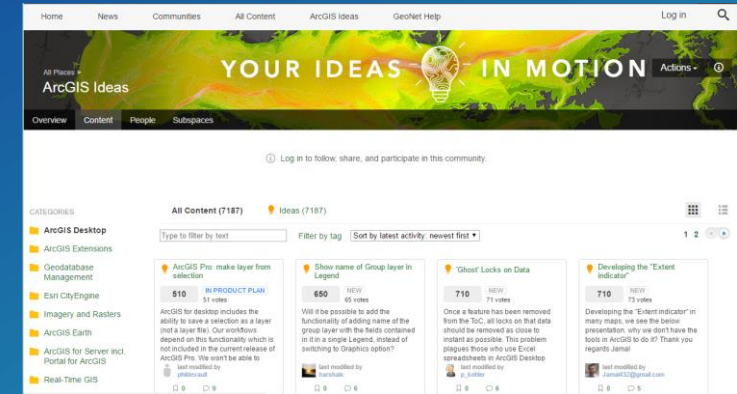

Ideas.ArcGIS.com

ArcGIS Pro Licensing



Named User

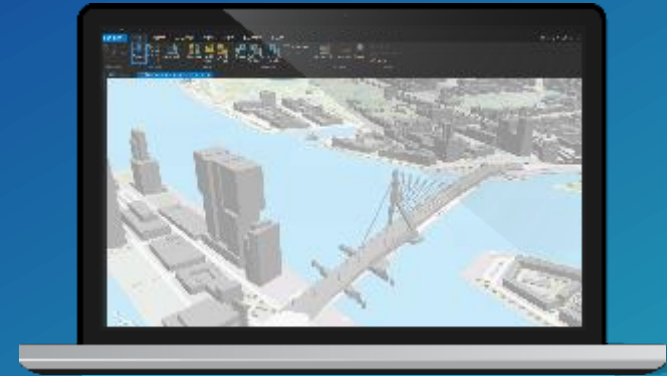

Single Use



Concurrent Use

ArcGIS Pro Roadmap

Near-term

- Utility Network
- Attribute Rules
- Reports
- Layout Tables
- Full Motion Video
- Stereo Mapping
- Oblique Imagery
- Interactive 3D Analysis
- Real Time Streaming
- Offline Web Maps & Layers
- SAP HANA
- New Extensions

Mid-term

- Parcel Management
- Dimensions
- Exploratory Spatial Data Analysis
- Spell Check
- ModelBuilder If-Then-Else Branching Logic
- Metadata Enhancements
- New Extensions

Long-term

- Animated Symbols
- Presentations
- Offset Printing
- ...

Panel Discussion

Questions and Feedback

Topics



Analysis & Geoprocessing in ArcGIS Pro

Is it faster?

About 10-20% for many tools. UX is more efficient.

esriurl.com/GPproFAQ

Does it have the same tools?

About 95% of the core ArcMap suite has been ported. Pro also has many new analytic tools that ArcMap does not have.

Can I use ArcGIS Online and Enterprise analysis tools?

Ready-to-Use service tools jump start your analysis and consume credits. Enterprise tools include Standard Feature, GeoAnalytics, and Raster Analysis.

Is interactive input supported? (ArcMap's Feature Sets)

Interactive input was added to a number of system tools in v2.0. Can also be used by custom tools. Full equivalency in 2.1.

What does multi-threaded processing mean?

You can do other tasks in the app while a tool is running.

Are tools licensed differently? How about analysis extensions?

Same as ArcMap.

Can I process the same data?

Personal GDB (.mdb) not supported, all other local and enterprise formats supported. Pro analysis natively supports layers from your Portal, service URLs, KML layers, and WFS layers.

Can I publish a geoprocessing service?

The Web GIS equivalent is sharing a web tool to your Enterprise. Support in 1.4.

What is the benefit of 64-bit processing?

64-bit is not about performance. It lets you load more data into memory. It is more robust and many processes that used to hang, crash, or run out of memory may complete successfully.

Does it use multiple cores to do parallel processing? How about GPU?

A growing list of tools support the PARALLEL PROCESSING FACTOR and GPU.

Can Pro run my models and scripts?

With very little or no modification. There are established patterns for writing Python that works in py2 and py3. *arcpy.mp

Any other reason to use Pro?

Charts are integrated in analysis workflow. R-ArcGIS bridge first-class citizen. Conda and Python Package Manager.

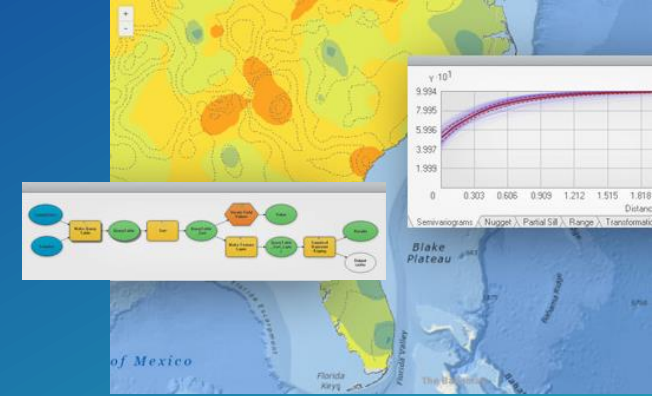

What's new in Pro Editing - 2017

- Multipatch Editor
 - Draw 3D multipatch features and place pre-defined 3D primitive shapes in scenes
 - Split, push and pull faces to create detailed 3D features
- Editing Grid
 - Configure the grid by specifying an origin, rotation, and spacing
 - Snap to and infer from the grid when drawing and modifying features
- Annotation Editing
 - Create horizontal text and edit on-screen
 - Reposition text and modify its baseline

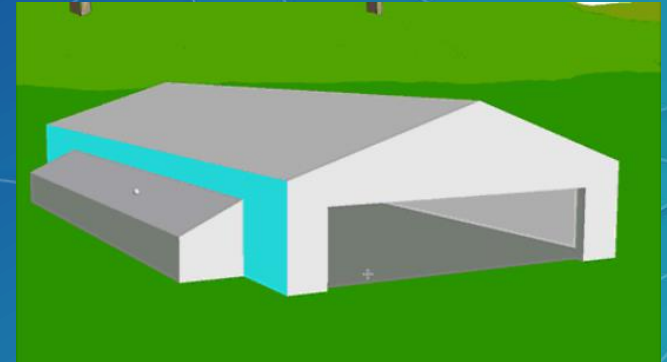

Thanks!



Please Take Our Survey on the Esri Events App!

Download the Esri Events app and find your event



Select the session you attended



Scroll down to find the survey



Complete Answers and Select "Submit"





esri

THE
SCIENCE
OF
WHERE